

EMORY C. CRUM
CITY ENGINEER
FREDERICK, MARYLAND



MAGNOLIA

AVE.

AVE

MARYLAND

W. SEVENTH ST.

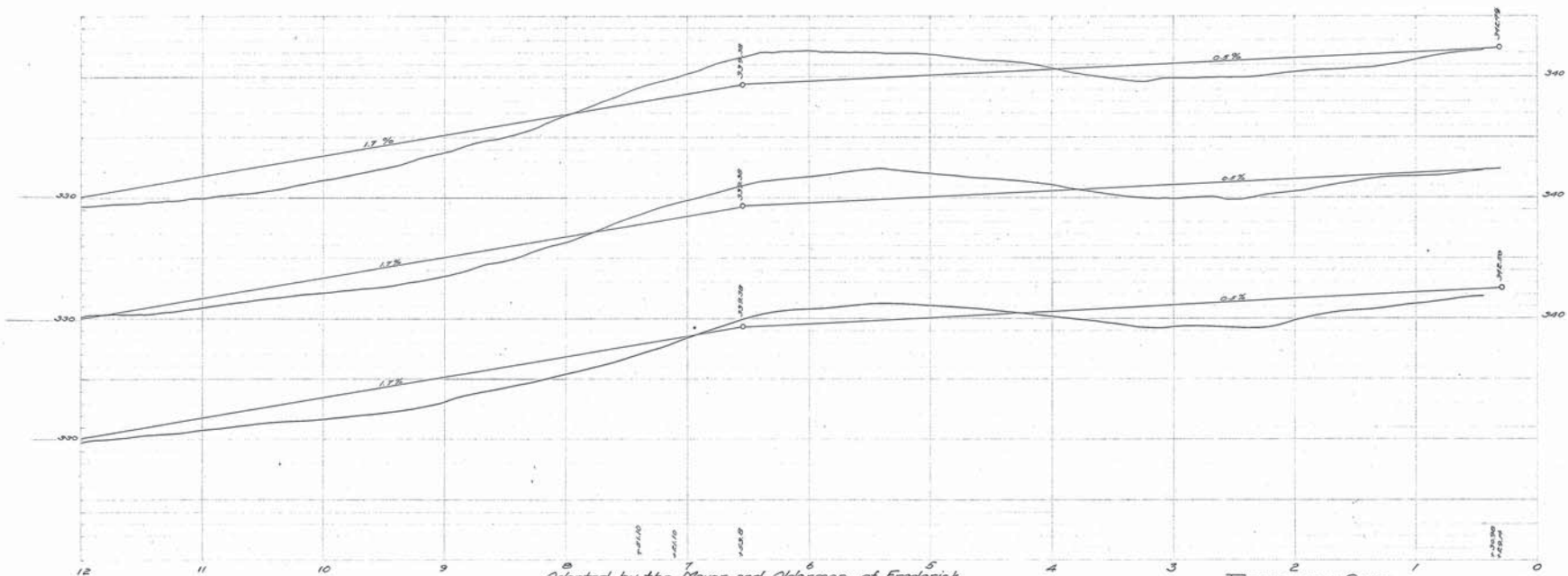

Adopted by the Mayor and Aldermen of Frederick
by ordinance passed and approved March 23, 1926.

Attest:-
Aubrey A. Richardson
City Registrar

The Mayor and Aldermen of Frederick
By *Joseph G. Bulley*
Mayor

FREDERICK CITY
PLAN & PROFILE of MAGNOLIA AVE.
SHOWING ESTABLISHED GRADE & STREET LINES
Frederick, Md.
April 7, 1926
SHEET 1 of 2 SHEETS

Scale: 1" = 40' HOR.
1" = 4' VERT.

No. 250407

No. 250407

PLAN & PROFILE 250407

MAGNOLIA AVENUE

250407-A
PLAN & PROFILE

MAGNOLIA AVENUE

EMORY C. CRUM
CITY ENGINEER
FREDERICK, MICHIGAN

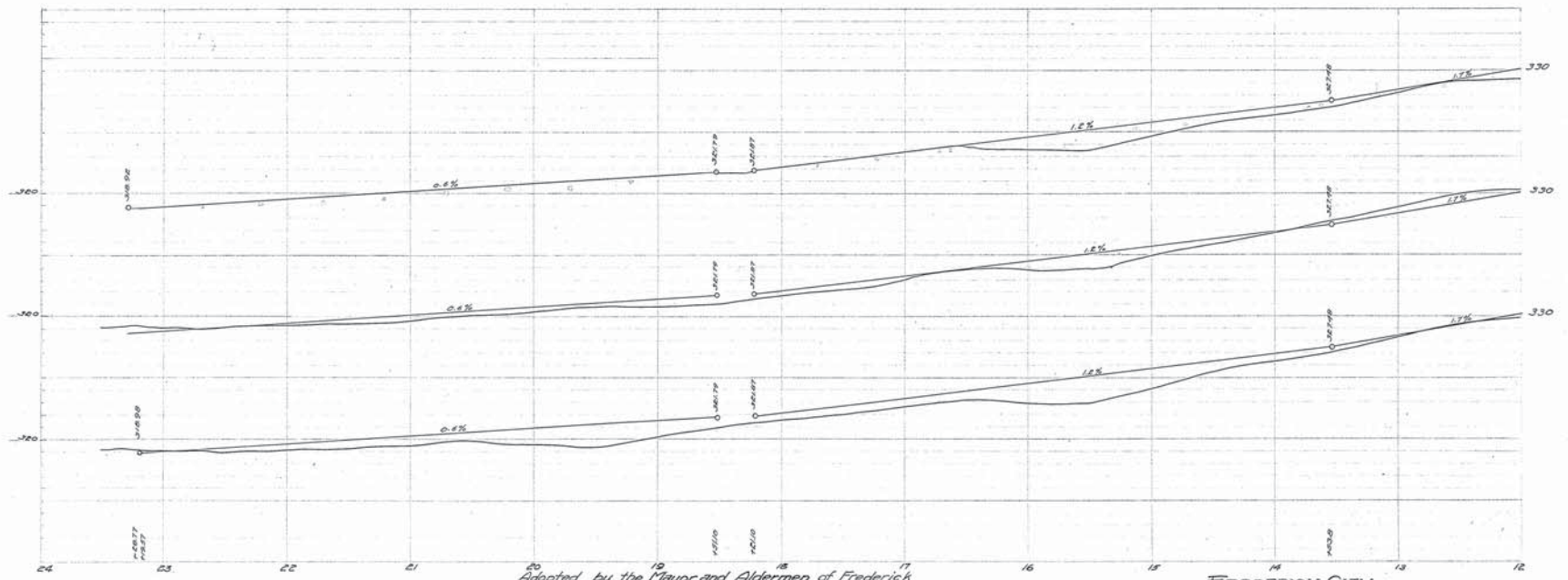
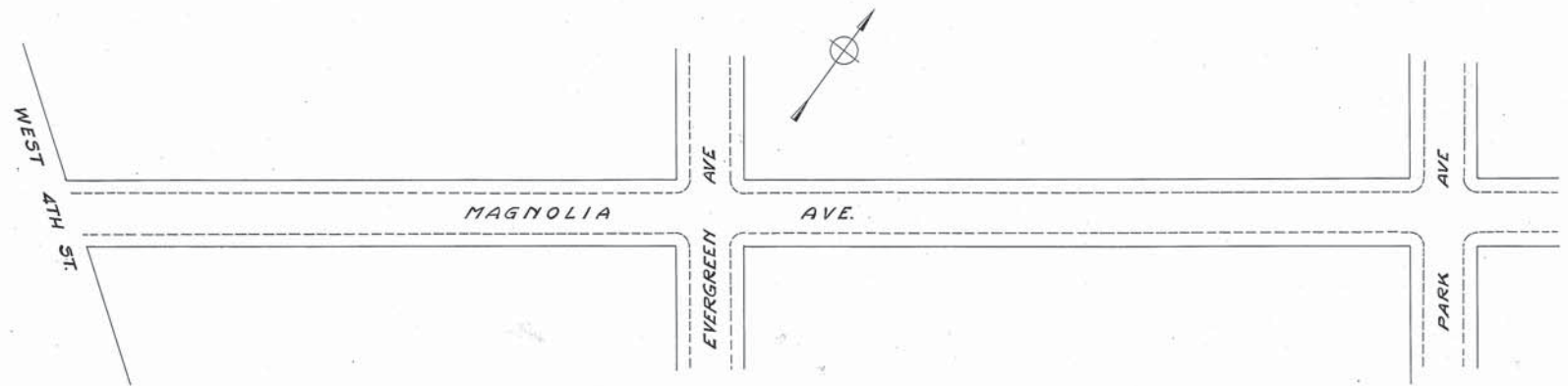

Adopted by the Mayor and Aldermen of Frederick
by ordinance passed and approved March 23, 1926.

Attest:-
Cahoy A. Nordmann
City Registrar

The Mayor and Aldermen of Frederick
By Lloyd G. Suller
Mayor

FREDERICK CITY
PLAN & PROFILE OF MAGNOLIA AVE.
SHOWING ESTABLISHED GRADE & STREET LINES
Frederick, Md.
April 7, 1925

Scales: 1"=40' HORIZ.
1"=4' VERT.

SHEET 2 OF 2 SHEETS

No. 650407A
P. 6. P. 2
D. 250407 A