

WESTINGHOUSE CHURCH, KERR & Co.  
ENGINEERS  
6 & 10 BRIDGE ST. NEW YORK

Drawn by J.S.G. & B.C.  
Checked by J.H.S. & T.C.

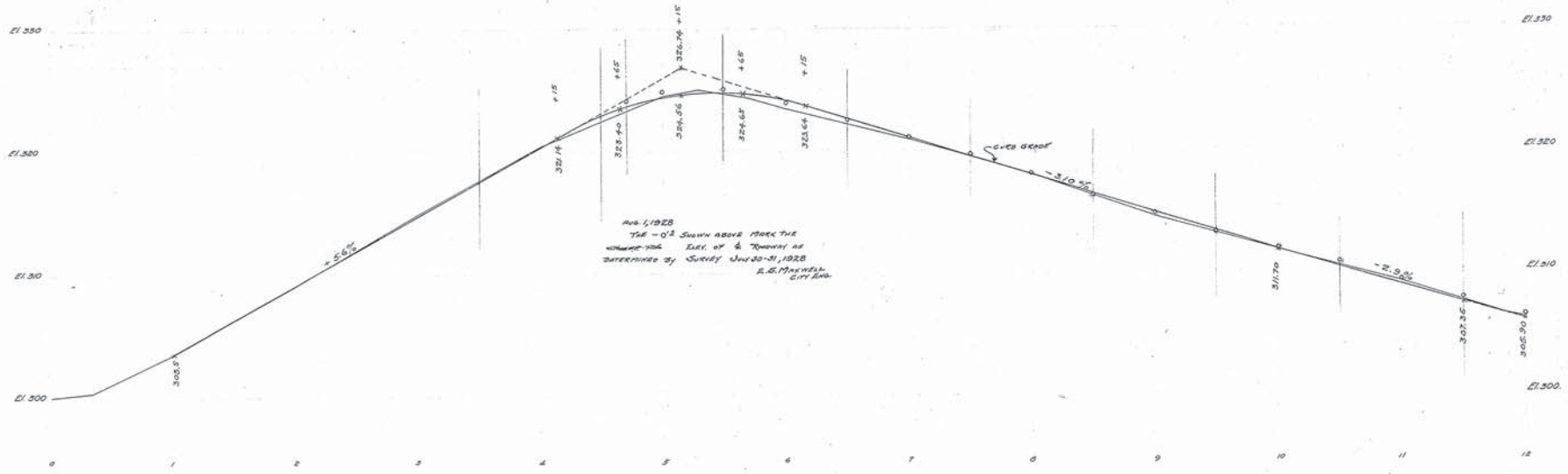

Note: The line shown in red and marked street line represents a line beyond which no buildings shall be built.  
The grade line shown on profile is an average grade between curbs.



Apr. 1, 1928  
T.M. - G.L. shown above 1909 the  
same as E.L. at 6' from as  
determined by Survey June 30, 1928  
R.E. Foxworth  
City Eng.

Adopted by The Mayor and Aldermen of Frederick  
by ordinance passed and approved Dec. 3, 1909

Attest:  
M. A. McCaffrey  
City Registrar

The Mayor and Aldermen of Frederick  
By *Edwin Smith* Mayor

FREDERICK CITY.  
PLAN & PROFILE OF PATRICK STREET I.  
SHOWING ESTABLISHED GRADE AND STREET LINE.  
Scales: 1" = 50 feet  
Frederick Md. Oct. 10 1907.  
Sheet 1 of 7 Sheets.

N.Y. N° 19866.

WESTINGHOUSE CHURCH, KERR & CO.

PATRICK STREET



Drawn by *C. G. K.*  
Checked by *H. R. S.*

WESTINGHOUSE GEORGE KERR & Co  
ENGINEERS  
6 & 10 BRUSH ST., NEW YORK.

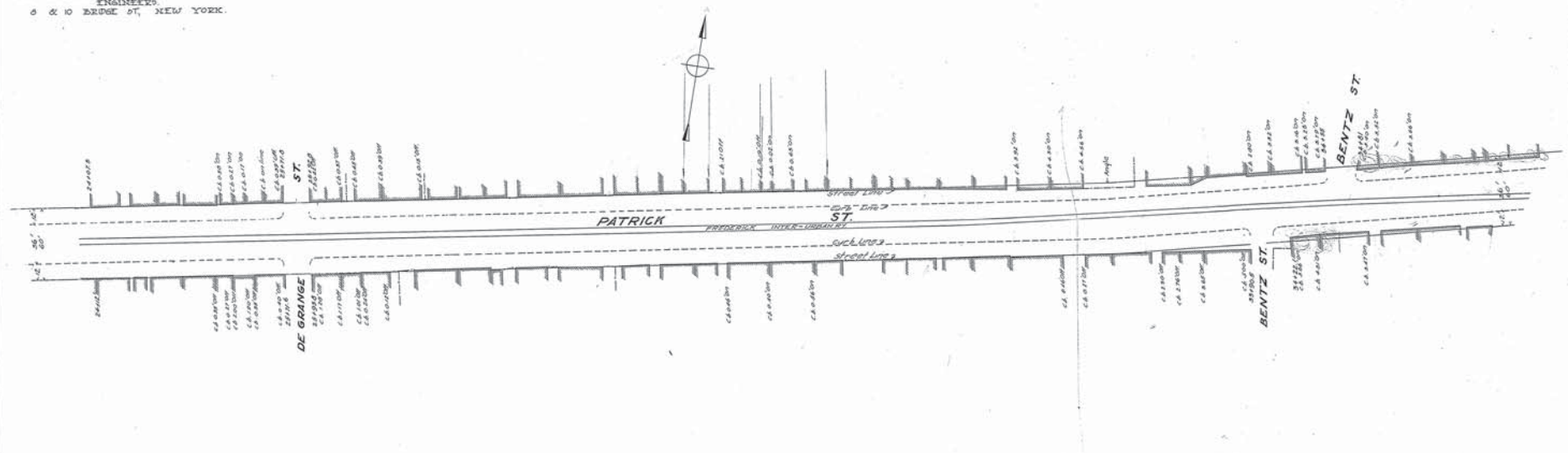

Note: The line shown in red and marked street line represents a line beyond which no buildings shall be built.  
The grade line shown on profile is an average grade between curbs.

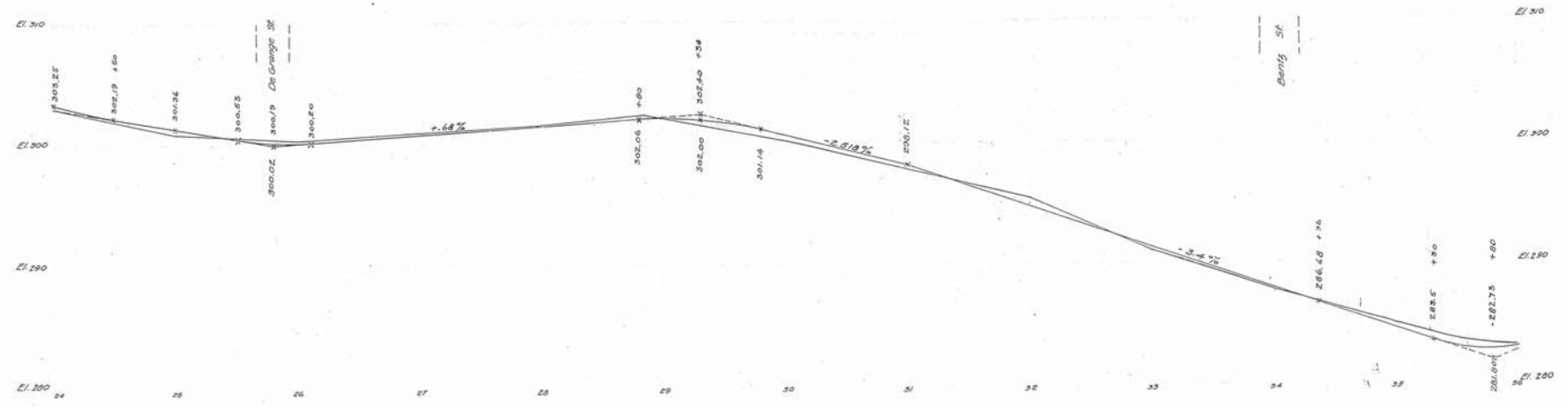

Adopted by The Mayor and Aldermen of Frederick,  
by ordinance passed and approved Dec. 3, 1909

Attest:  
*M. W. McCaffrey*  
City Registrar

The Mayor and Aldermen of Frederick,  
By *Edw. Smith* Mayor.

FREDERICK CITY.  
PLAN & PROFILE OF PATRICK STREET.  
SHOWING ESTABLISHED GRADE & STREET LINE.  
Scale: 1" = 40' Vert.  
1" = 20' Hor.  
Frederick Md  
Oct. 10 1907.  
Sheet 3 of 7 Sheets.

N.Y.N°19868  
P. 2 - P. 1

WESTINGHOUSE CHURCH, KERR & CO.

PATRICK STREET

19868

Drawn by J.G.M.C.  
Checked by M.S.T.

WESTINGHOUSE CHURCH KEER & Co.  
ENGINEERS.  
6 & 10 BRIDGE ST. NEW YORK.

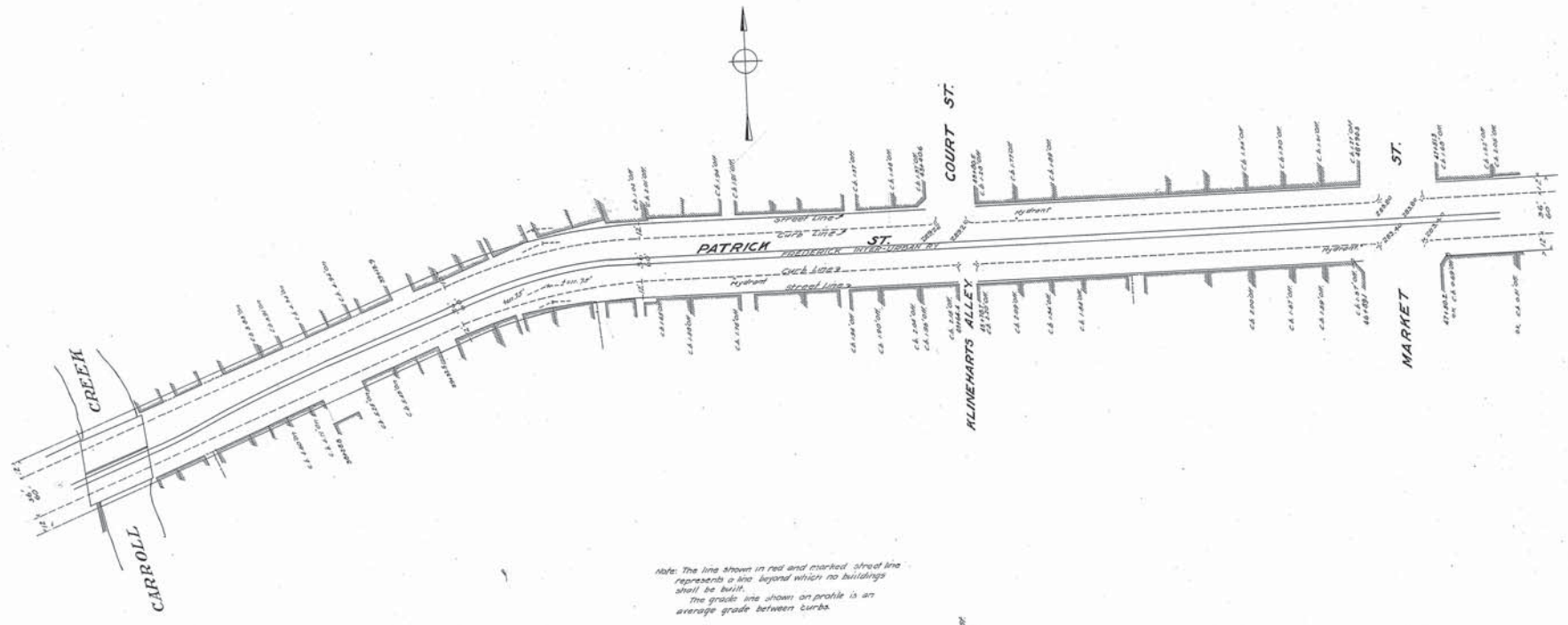

Note: The line shown in red and marked street line represents a line beyond which no buildings shall be built.  
The grade line shown on profile is an average grade between curbs.

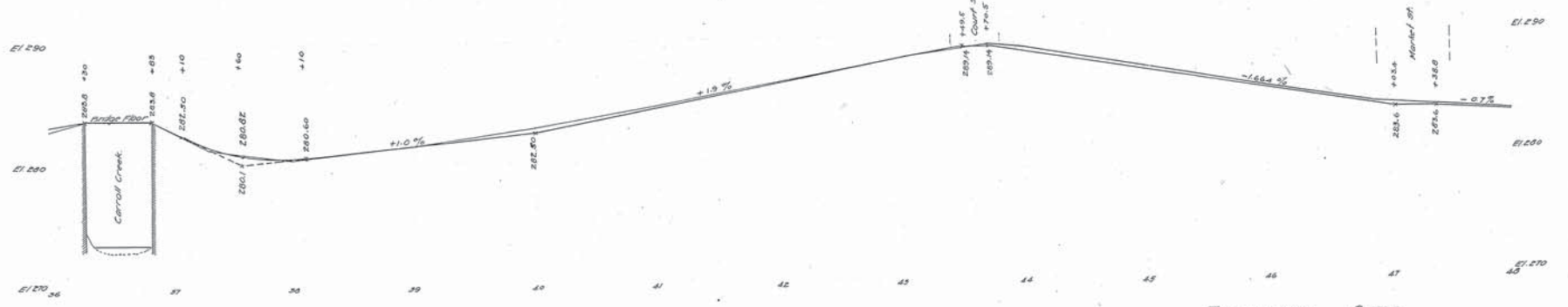

Adopted by The Mayor and Aldermen of Frederick.  
by ordinance passed and approved Dec. 3, 1909

Attest:  
*W.A. McCaffrey*  
City Registrar.  
The Mayor and Aldermen of Frederick  
By *Edw. Smith* Mayor

FREDERICK CITY.  
PLAN & PROFILE OF PATRICK STREET.  
SHOWING ESTABLISHED GRADE OF STREET LINE.  
Frederick Md. Oct 10 1907.  
Sheet 4 of 7 Sheets.

N. Y. No 19869  
P.L.F.

WESTINGHOUSE CHURCH, KERR & CO. 19869

PATRICK STREET



Drawn by J.O. & R.C.  
Checked by G.F. S. S.

WESTINGHOUSE CHURCH KERR & Co.  
ENGINEERS  
8 & 10 BRIDGE ST, NEW YORK.

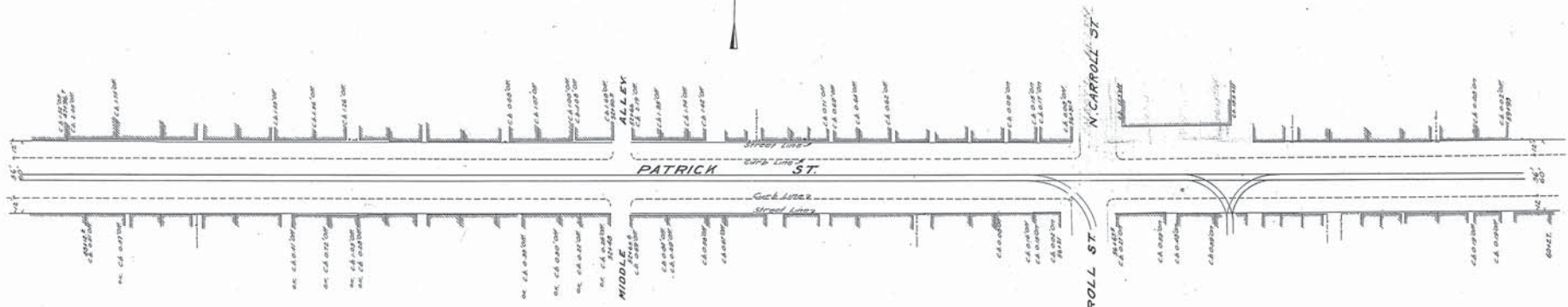

Note: The line shown in red and marked street line represents a line beyond which no buildings shall be built.  
The grade line shown on profile is an average grade between curbs.

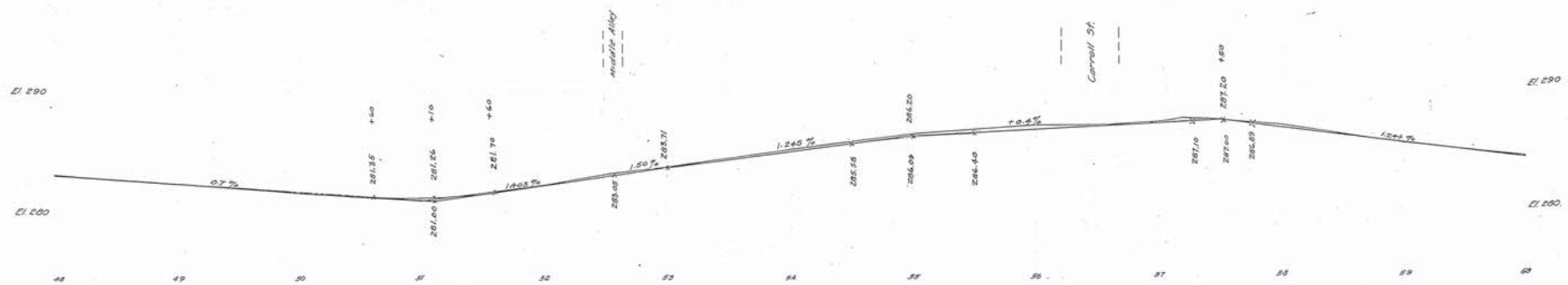

Adopted by The Mayor and Aldermen of Frederick  
by ordinance passed and approved Dec. 3, 1909

Attest:-  
M. A. McCaffrey  
City Registrar

The Mayor and Aldermen of Frederick  
By: W. E. Smith Mayor.

FREDERICK CITY.  
PLAN & PROFILE OF PATRICK STREET.  
SHOWING ESTABLISHED GRADE AND STREET LINE.  
Scale: 1" = 40' Vert.  
1" = 20' Hor.  
Frederick Md.  
Oct. 10, 1907.  
Sheet 5 of 7 Sheets.

N. Y. No. 19870.

PATRICK STREET

19870

WESTINGHOUSE, CHURCH KERR & Co.  
ENGINEERS.  
8 & 10 BRIDGE ST. NEW YORK

Drawn by J.A. & R.C.  
Checked by P.S. & J.A.

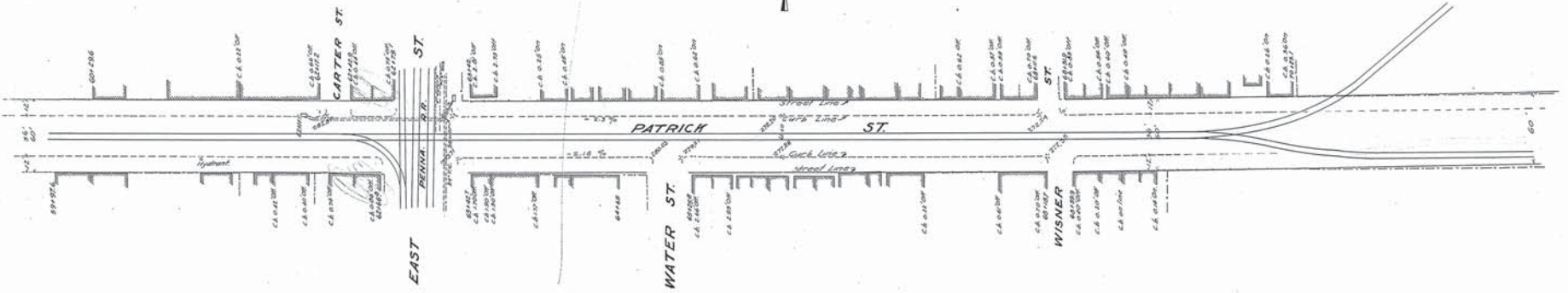

Note: The line shown in red and marked street line represents a line beyond which no buildings shall be built.  
The grade line shown on profile is an average grade between curbs.

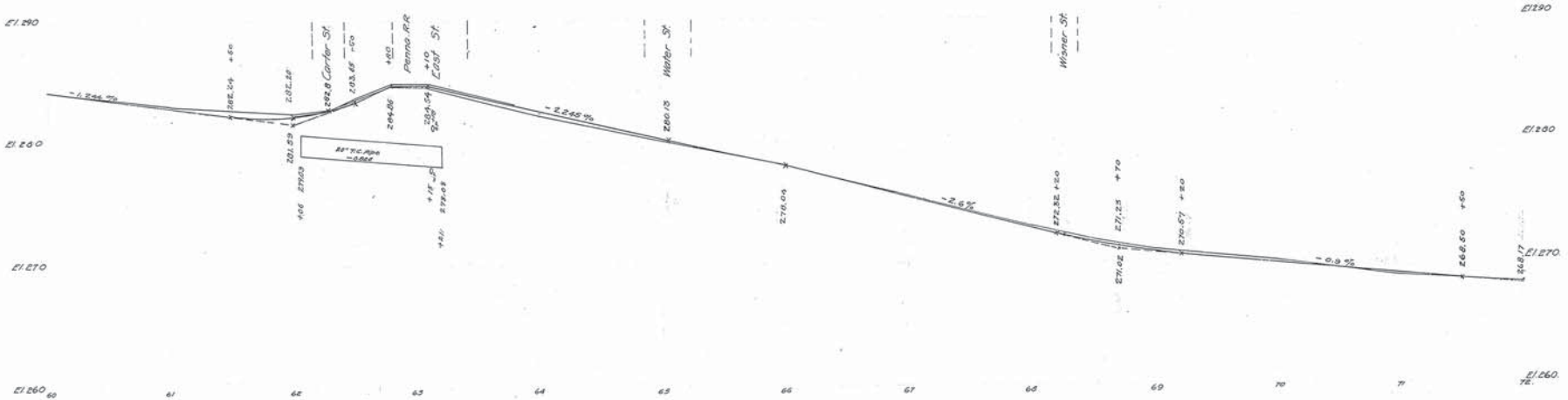

Repealed and re-enacted by ordinance passed and approved June 3, 1921.

Adopted by The Mayor and Aldermen of Frederick, by ordinance passed and approved Dec. 3, 1909

Attest-  
John J. White,  
City Registrar

The Mayor and Aldermen of Frederick  
By  
John S. Kelly Mayor

Attest-  
M. A. McCaffrey  
City Registrar

The Mayor and Aldermen of Frederick  
By  
Edw. Smith Mayor

FREDERICK CITY.  
PLAN & PROFILE OF PATRICK STREET.  
SHOWING ESTABLISHED GRADE & STREET LINE.  
Scales 1" = 40' Vert. 1" = 20' Hor.  
Frederick Md. Oct. 12, 1907.  
Sheet 6 of 7 Sheets.

N.Y. No 19871.

WESTINGHOUSE CHURCH, KERR & CO.

PATRICK STREET

PL-6-7-1

Drawn by J.O. & B.C. 7  
Checked by R.C. J.C.

WESTINGHOUSE CURRISH KERR & Co.  
ENGINEERS  
6 & 10 BRIDGE ST, NEW YORK.

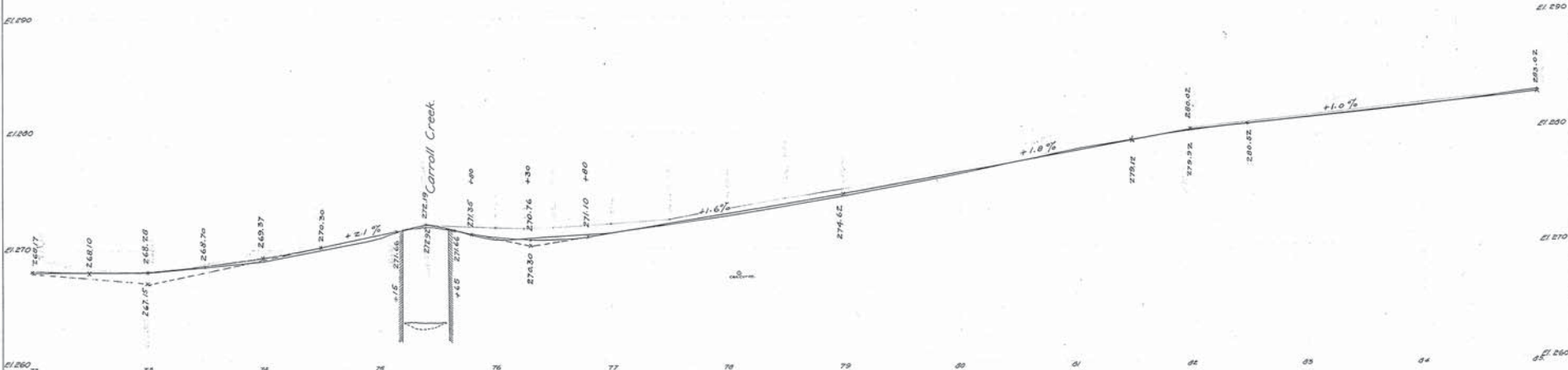
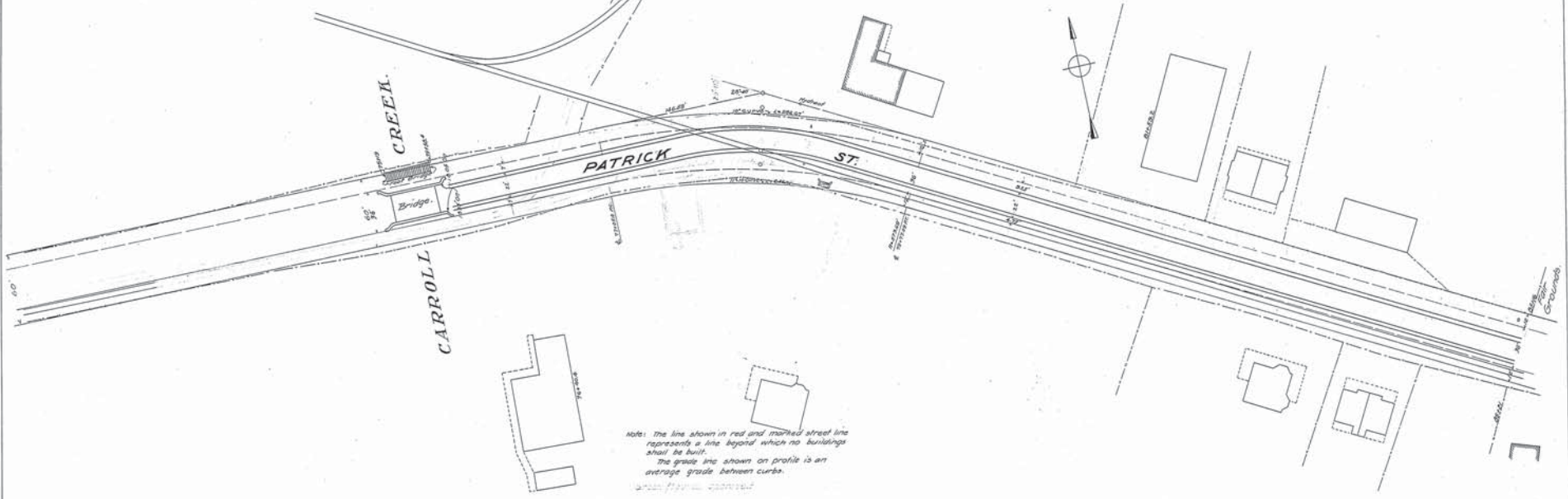

Repealed and re-enacted by ordinance  
passed and approved June 3, 1921.

Adopted by The Mayor and Aldermen of Frederick,  
by ordinance passed and approved Dec. 3, 1909.

Attest:-  
*John J. White*  
City Registrar

The Mayor and Aldermen of Frederick  
By *Gilmer Sahley*  
Mayor

Attest:-  
*M.A. McCaffrey*  
City Registrar

The Mayor and Aldermen of Frederick.  
By *Geo. Edw. Smith* Mayor.

FREDERICK CITY.  
PLAN & PROFILE OF PATRICK STREET.  
SHOWING ESTABLISHED GRADE & STREET LINE.  
Scales: 1" = 40' vert. 1" = 40' hor.  
Frederick, Md. Oct 12 1907.  
Sheet 7 of 7 Sheets.

N.Y. No. 19872.  
P.L.F.1

19872

WESTINGHOUSE CHURCH, KERR & CO.

PATRICK STREET